

Schüco In-Roof Mounting System MSE 210

Perfect integration of photovoltaic modules in the roof covering



SCHÜCO

Overview of entire system

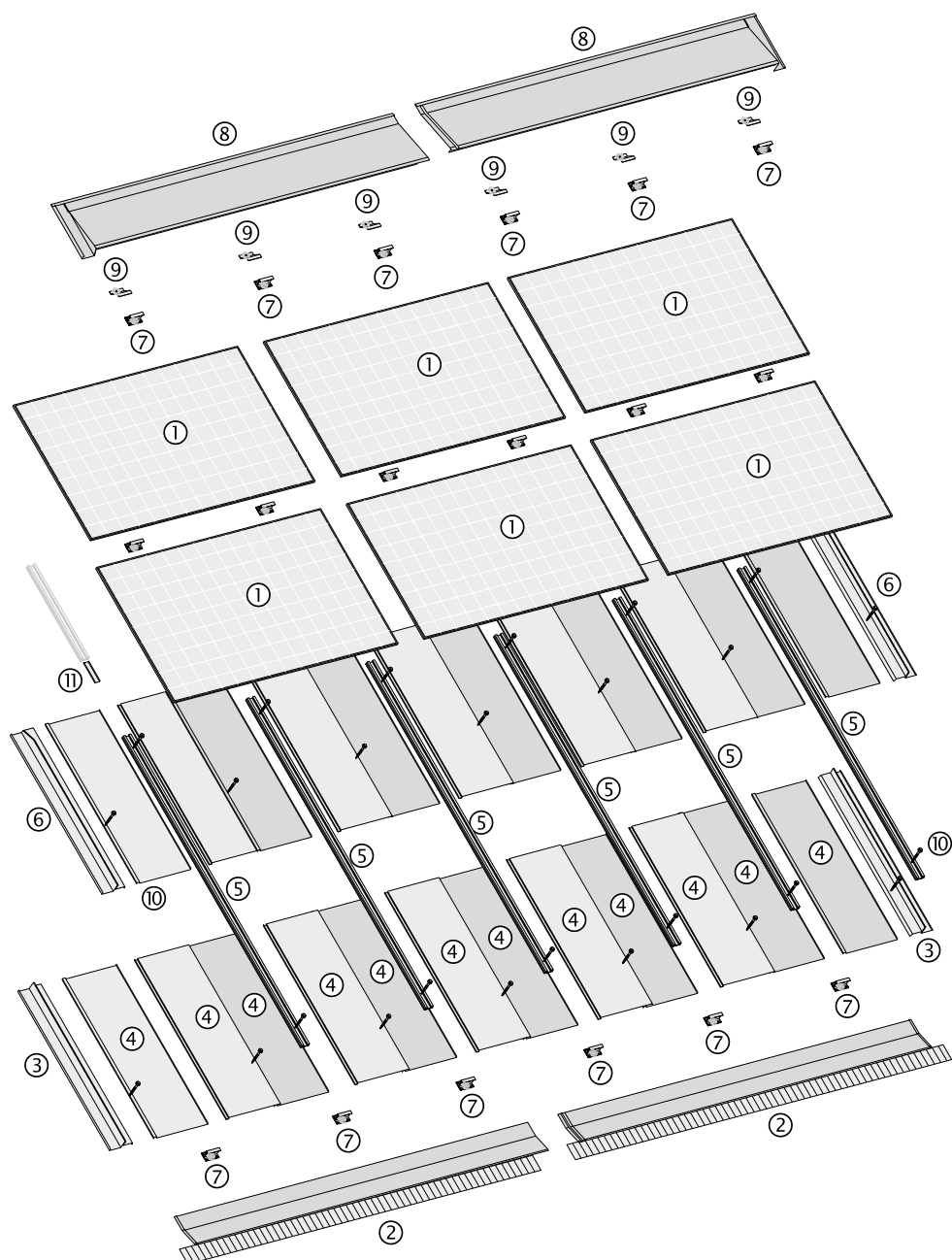

Diagram of the module area of 5100 × 2000 mm (corresponds to a corner base)

Key:

Mounting system	
①	Modules
②	Bottom cover plates
③	Side cover plates
④	Troughs
⑤	Vertical profiles
⑥	Side cover plates / extension
⑦	Module clips
⑧	Top cover plates
⑨	Module clip, top cover plate fixing
⑩	Self-drilling screws
⑪	T-support for vertical profile

— Corner base article

Corner base and extension kit

All currently available standard modules can be integrated elegantly into the building roof using the Schüco MSE 210 mounting system. The flush roof surface results in a particularly elegant roof-line.

The mounting frame is designed as a watertight flashing, making a conventional roof covering superfluous. It is just as possible to implement a complete roof solution as it is to integrate smaller module fields into the existing roof covering.

Corner base

For a maximum module area of 5100 × 2000 mm. For larger modules, extension kits are required for the corner base.

Corner base consists of:

- Top cover plates left and right ⑥
- Side cover plate extension, left and right ⑥
- Bottom cover plates, left and right ②

- Side cover plate extension, left and right ⑥
- Bottom cover plates, left and right ②

Corner base designs	
22° in grey RAL 7035	Art. No. 257 359
22° in brown RAL 8019	Art. No. 257 366
22° in black RAL 9005	Art. No. 271 668
15° in grey RAL 7035	Art. No. 257 575
15° in brown RAL 8019	Art. No. 257 841
15° in black RAL 9005	Art. No. 271 669

Extension kits for the corner base

Horizontal extension (left and right), Dimensions 1700 × 150 mm	
22° in grey RAL 7035	Art. No. 257 360
22° in brown RAL 8019	Art. No. 257 844
22° in black RAL 9005	Art. No. 271 672
15° in grey RAL 7035	Art. No. 257 647
15° in brown RAL 8019	Art. No. 257 842
15° in black RAL 9005	Art. No. 271 673

Vertical extension, dimensions 170 × 1180 mm	
Grey, RAL 7035	Art. No. 257 361
Brown, RAL 8019	Art. No. 257 843
Black, RAL 9005	Art. No. 271 671

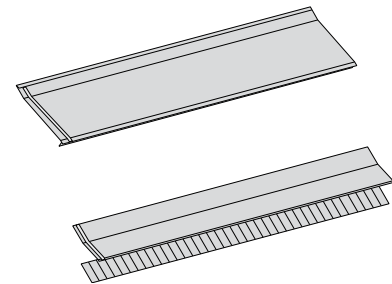

Horizontal extension

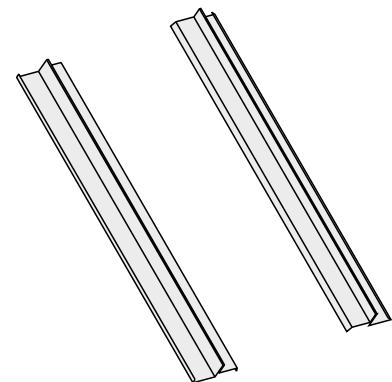

Vertical extension

Profiles, troughs and self-drilling screws

Profiles and troughs

	Material, dimensions	Art. No.
Vertical profile	Aluminium, mill finish, Length 6150 mm	259 862
Trough	Aluminium, mill finish, 1180 × 420 mm	257 350
Self-drilling screw	Stainless steel, Length 50 mm	257 698

Mounting and fixing

- Mounting the vertical profiles ⑤ on the bottom cover plate and fixing on the battens with self-drilling screws
- Attaching the troughs ④ to the profile and fixing to the batten

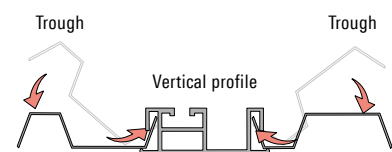

Installing the troughs using the vertical profile

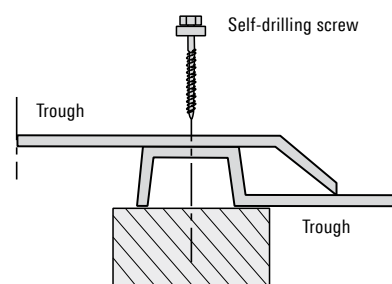

Fixing the trough using the self-drilling screws

Module clip and gasket kit

Module clip

- Module clip, top cover plate fixing ⑨
- Module clip for frame type 3 ⑦
- Universal module clip (alternative to module clip for frame type 3)

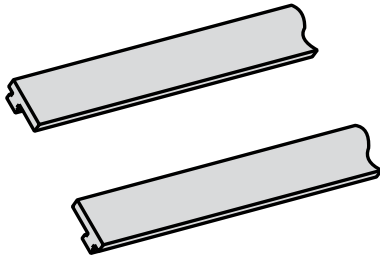

Gasket kit, two gaskets per module clip

Installing and fixing modules with module clips

The module clips for frame type 3 is required to fix the modules with Schüco frame type 3.

Universal module clips can be used for other frame types. Suitable gasket kits are also required here.

The module clip is then aligned, appropriately positioned and fixed to the module.

Module clips	
Module clip for frame type 3 Aluminium, mill finish	Art. No. 259 864
Module clip for frame type 3, Brown, RAL 8019	Art. No. 259 815
Module clip for frame type 3, Black, RAL 9005	Art. No. 271 898
Universal module clip Aluminium, mill finish	Art. No. 259 863
Universal module clip Brown, RAL 8019	Art. No. 259 814
Universal module clip Black, RAL 9005	Art. No. 271 899
Module clip, top cover plate fixing, Aluminium, mill finish	Art. No. 259 865

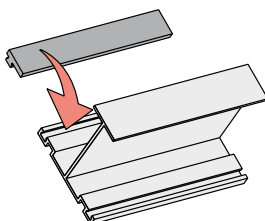

Installing the gasket in the universal module clip

Selecting gasket kits for the universal module clip

To compensate for the height of different module frame heights from 41 to 51 mm.

Frame height [mm]	Gasket kit (Art. No.)	Difference [mm]
51		0
50	257 681	1
49	257 682	2
48	257 683	3
47	257 684	4
46	257 685	5
45	257 686	6
44 - 43	257 687	7 - 8
42 - 41	257 688	9 - 10

Cover rails (optional)

For a neat finish between the bottom cover plate and the universal module clips and module clips for frame type 3.

Contents:

5 guide rails (length 1730 mm) and 10 special self-drilling screws

Guide rail (module clip for frame type 3)	
Guide rail, grey, RAL 7035	Art. No. 259 385
Guide rail, brown, RAL 8019	Art. No. 259 386
Guide rail, black, RAL 9005	Art. No. 271 670

Guide rail (universal module clips)	
Guide rail, grey, RAL 7035	Art. No. 259 219
Guide rail, brown, RAL 8019	Art. No. 259 220
Guide rail, black, RAL 9055	Art. No. 271 900

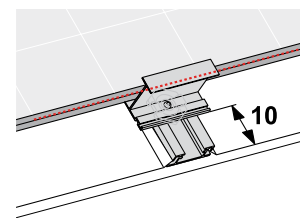

Position the module clip on the vertical profile

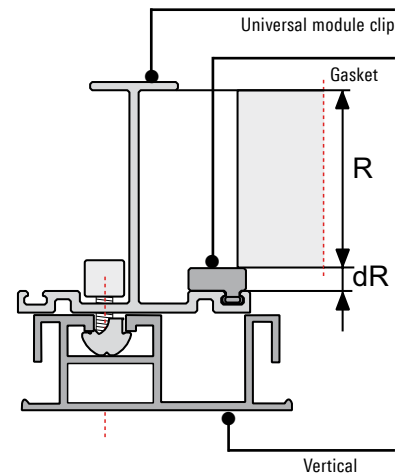

Universal module clip mounted on the vertical profile

Accessories

- Installation spanner to fix the module clips
- SchücoFlex 2 sealing compound to seal the vertical profile joint with the vertical profile
- T-support ⑩ to attach the vertical profiles

Accessories	
Hexagon-head screwdriver	Art. No. 221 089
SchücoFlex 2	Art. No. 298 900
T-support for vertical profile	Art. No. 257 672

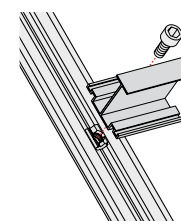

Installation of the module clip on the vertical profile

Features

- A mounting system for all framed modules with frame type 3 and other modules with a frame height of 41 mm to 51 mm
- Landscape orientation of the modules
- The system can be extended to cover the whole roof
- Watertight design with rainproof trough construction
- No additional sealing required for the system
- Narrow profile face widths provides optimum use of space and an elegant look
- System can be installed from a roof pitch of 15°
- Three different standard colour designs in grey RAL 7035, brown RAL 8019 and black RAL 9005
- Other colour designs available on request.
- Installation of the modules using various module clips for different frame heights

Schüco – Your partner for windows and solar products

As leading innovator in system-based construction, Schüco supplies components for the entire building envelope, including specialised software solutions for design, construction, calculation and fabrication.

- Aluminium systems
- Steel systems
- PVC-U systems
- Solar products
- Schüco Design



Schüco Mounting System MSE 210 In-Roof

Key benefits

- Flexible solutions for mounting on different roof structures
- Replaces conventional roof coverings and can even provide a complete roof solution
- Edge covering available in all RAL colours on request
- Modules installed in landscape orientation
- Optimum rear ventilation for high energy output
- Optimised load limits for wind and snow loads
- Suitable for roof pitches from 15°

Schüco International KG
www.schueco.com

